



Waterproofing system for waterproof-concrete joints

Triflex JWS – Version 1

System drawings

Version 1: Controlled crack joint, construction joint, settlement joint – surface

System design – Detail A

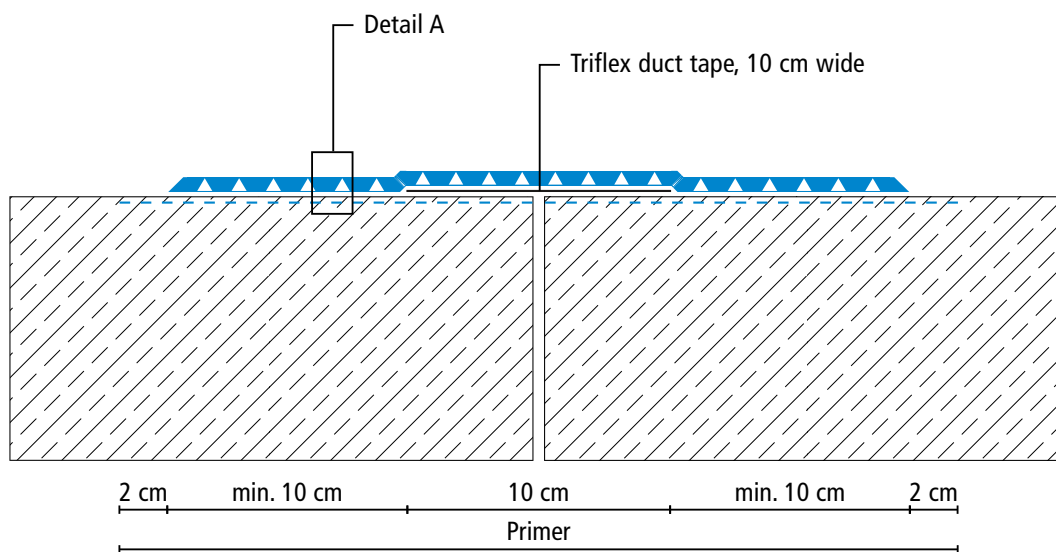
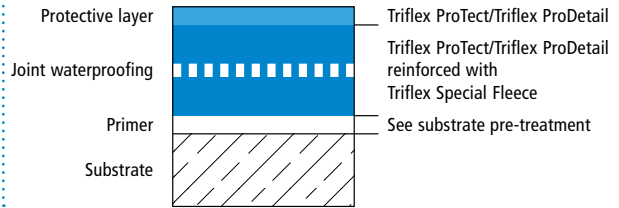

Drawing no.: JWS-5101

Height differences between fleece overlaps are exaggerated

Waterproofing system for waterproof-concrete joints

Triflex JWS – Version 1



System drawings

Version 1: Controlled crack joint, construction joint, settlement joint – wall junction

System design – Detail A

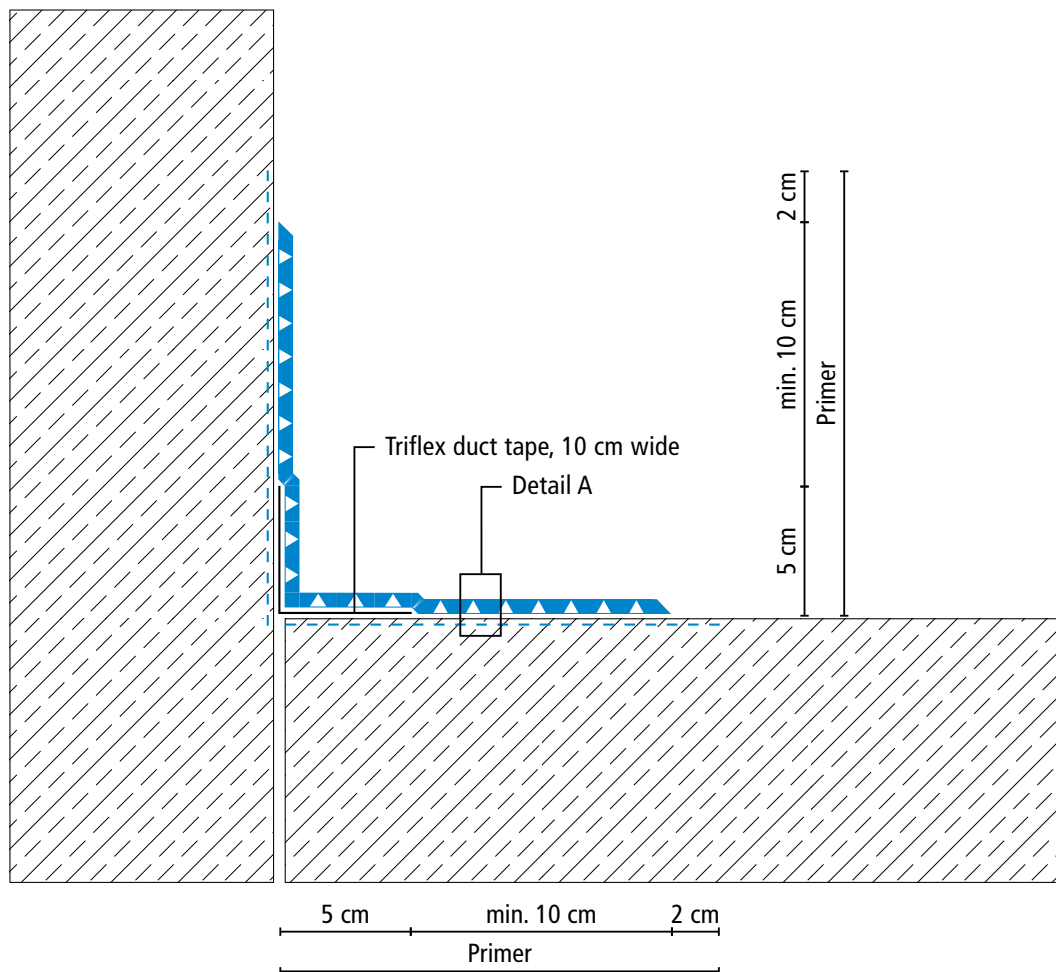
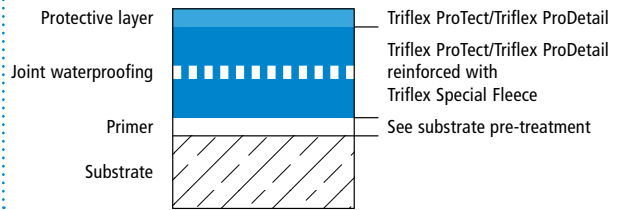

Drawing no.: JWS-5102

Height differences between fleece overlaps are exaggerated

Triflex JWS – Version 2



System drawings

Version 2: Settlement joint surface

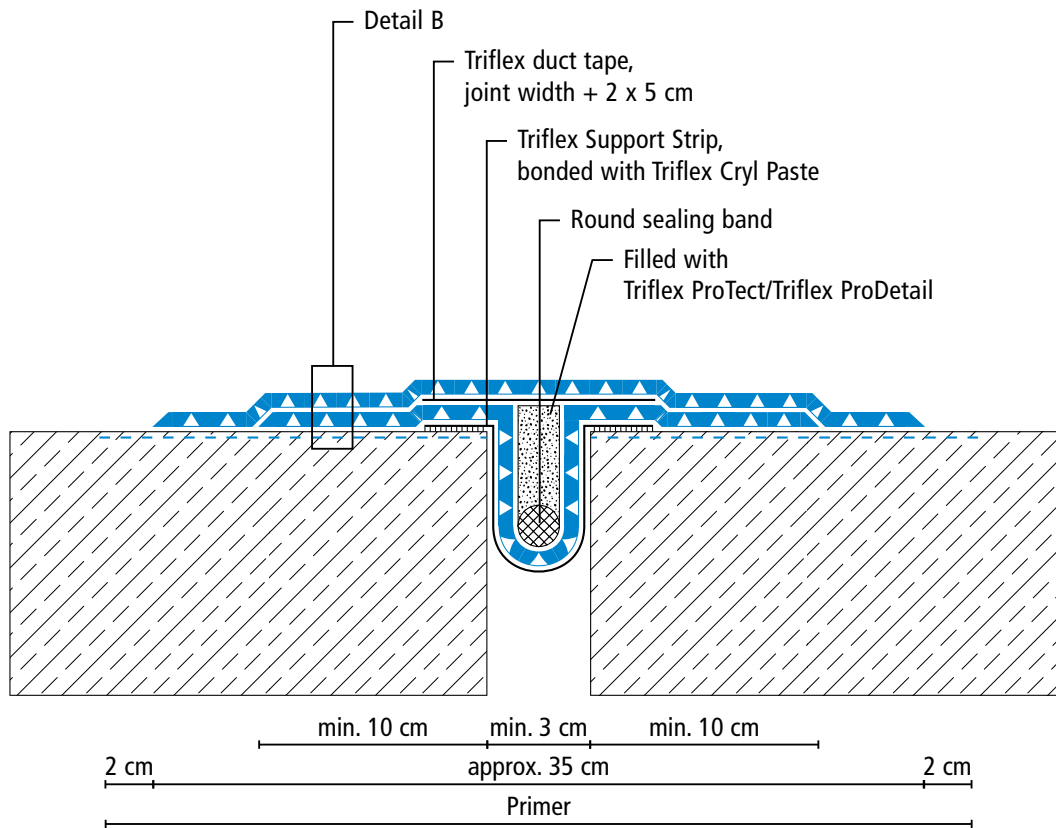
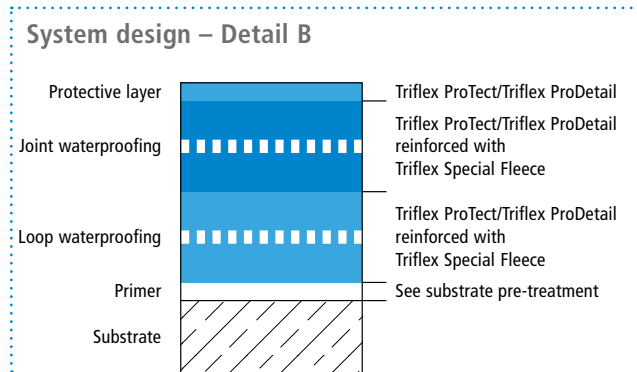

Drawing no.: JWS-5103

Height differences between fleece overlaps are exaggerated

Triflex JWS – Version 2



System drawings

Version 2: Settlement joint – wall junction

System design – Detail B

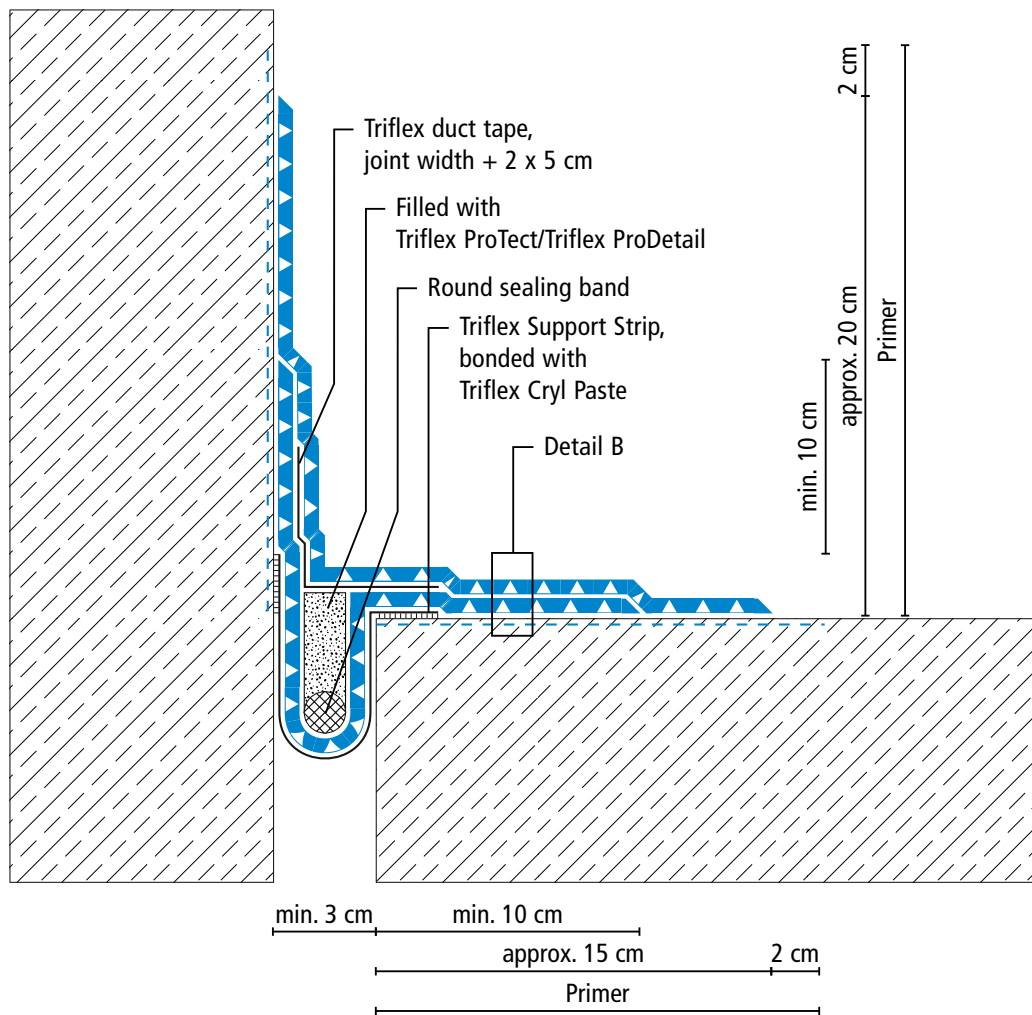
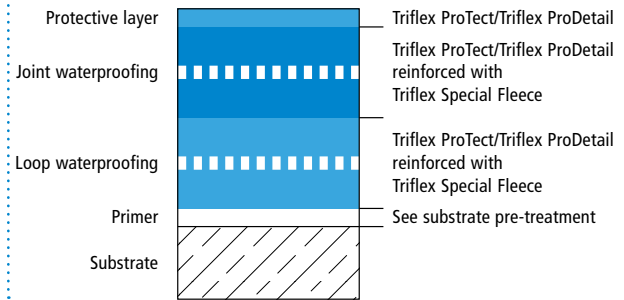

Drawing no.: JWS-5104

Height differences between fleece overlaps are exaggerated