

Triflex

Delivering solutions together.

Planning documents

Detail Waterproofing System

Triflex ProDetail®





Applications



It is not just surface waterproofing that ensures the water-tightness of a flat roof, the solution for joints and details is also crucial. Just one single weak point compromises the functionality of the overall layer structure.

In the case of single repairs, or a complete refurbishment, the number and complexity of the details may well be the key factor in the decision to use liquid applied waterproofing. Only liquid applied waterproofing is able to mould itself exactly to the details of the roof and provide a seamless and joint-free solution.

Triflex has almost 40 years experience of using durable waterproofing and coating systems in the world of building refurbishment. **Triflex ProDetail** is a waterproofing system developed specially for joints that ensures the lasting reliable protection of details.

Fast and reliable

Generally speaking, leaks in a flat roof are only noticed when the premises underneath show signs of dampness. For this reason, damage tends to occur in the cold seasons. Triflex ProDetail is factory-set so that it can be used at substrate temperatures of -5°C . The liquid Triflex ProDetail is rainproof after approx. 30 minutes and completely cured in approx. 45 minutes. Repairs can therefore be reliably performed in all weathers.

Universal detail solutions

Triflex ProDetail is ideal for a whole host of applications. As well as being a repair material, it is also used as a detail solution in the Triflex ProTect roof surface system. The waterproofing resin has technical properties which also make it suitable for use in Triflex systems on balconies and in car parks. Triflex ProDetail is also a proven performer in special applications, such as the preservation of monuments.



Advantages at a glance

Waterproof down to the smallest detail

The cured resin forms a seamless and joint-free surface. Even complex details, such as ventilation pipes in close proximity to each other, or H-beams, can be homogeneously waterproofed using liquid applied waterproofing.

Highly resilient with dynamic crack-bridging

The fully reinforced system offers a level of flexibility that leaves it unaffected by any movement of the other functional layers.

Ideal for refurbishments

The vapour-permeable system can be applied to virtually all substrates, without primer in the majority of cases.

Short reaction times

The liquid applied system has particularly rapid curing times.

The waterproofing resin is fully functional after just 45 minutes. This ensures reliable processing – even in changeable weather and at substrate temperatures of down to -5°C .

Reliable application

The liquid applied waterproofing is factory prepared as a thixotropic formulation in order to prevent the resin from sliding off vertical surfaces. The full-surface bonding with the substrate means there is no underflow of rainwater. Mechanical fastening at the upper edge is not required.

Certified safety

Triflex ProDetail has obtained European Technical Approval (ETA) and meets the requirements of the Construction Products Directive of the EU (CE marking). Its root resistance is also certified acc. to FLL standards (EN 13948). In addition, Triflex ProDetail meets the requirements of DIN 18195 Parts 4 to 7 and DIN 18531 Parts 1 to 4.

Detail Waterproofing System Triflex ProDetail®



And this is how it's done ...



1. Seal off intersections between skylight and refurbishing rim with adhesive tape.



2. Mix partial quantity thoroughly with the respective amount of catalyst additive.



3. Apply generous coating of Triflex ProDetail.



4. Work the Triflex Special Fleece into the laid material, making sure that there are no air bubbles.



5. Cut into the fleece at the corners and apply another generous coat of Triflex ProDetail.



6. Follow the same procedure to bond to the surface.



7. The waterproofing is rainproof after just 30 minutes.



8. Triflex ... waterproof down to the smallest detail!



Compatible system components

All the Triflex products mentioned in this system are lab-scale and application coordinated as a result of years of experience. This standard of quality ensures optimum results during both application and use.

Detail Waterproofing System

Triflex ProDetail®



System description

Properties

- Fully reinforced detail waterproofing system with a polymethyl methacrylate (PMMA) base
- Seamless
- Cold-applied
- Fast-curing
- Flexible in low temperatures
- Excellent adhesion properties on a multitude of substrates
- Root-resistant in line with FLL
- Can be used at substrate temperatures of down to -5 °C
- Extremely weather-resistant (UV, IR, etc.)
- Elastic and crack-bridging
- Vapour-permeable
- Resistant to chemicals present in air and rainwater
- Resistant to external fire exposure to DIN 4102 / DIN EN 13501
- European Technical Approval with CE mark in the highest usage categories (W3, M and S, P1 to P4, S1 to S4, TL4, TH4)
- Complies with DIN 18531 (2010 version)
- Approved to DIN 18195 Parts 4 to 7
- Can also be used for other applications, such as balconies and parking decks

System design

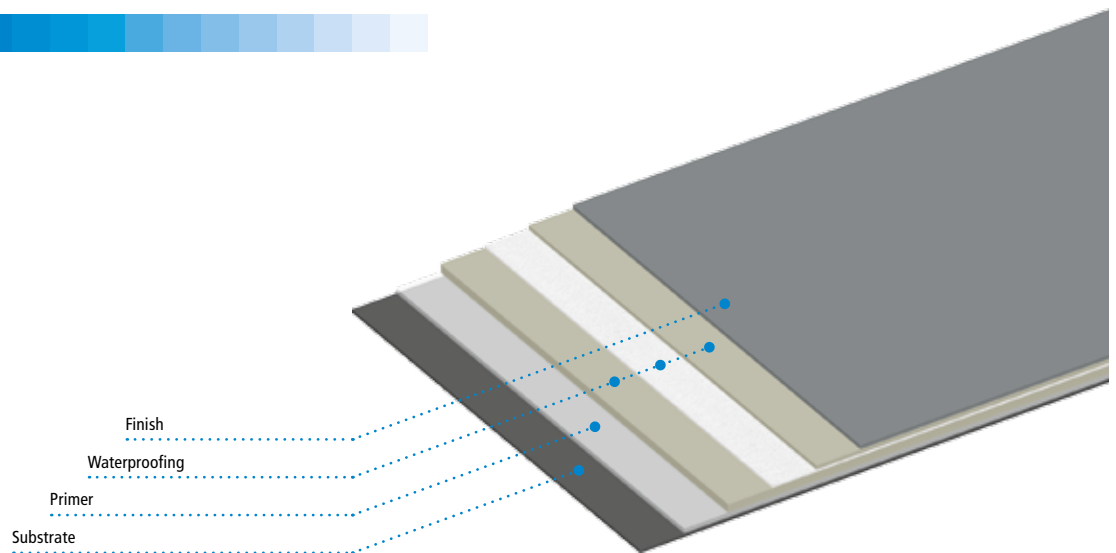

System components

Primer

Triflex Primer for sealing the substrate and ensuring substrate adhesion (if necessary, see table substrate pre-treatment).

Waterproofing

Triflex ProDetail waterproofing membrane, fully reinforced with a sturdy Triflex Special Fleece made of polyester.

Finish

Triflex Cryl Finish 205, wear-resistant system finish (if desired, to the optical design).

Substrate

Substrate suitability should always be checked on a case by case basis. The substrate must be clean, dry and free of cement bloom, dust, oil, grease and other adhesion-reducing dirt.

Moisture: When carrying out waterproofing work, the substrate moisture must not exceed 6 % by weight. Ensure that structural measures are taken to prevent moisture penetration of the coating from underneath.

Dew point: During application, the surface temperature must be at least 3 °C above the dew point temperature. Below this temperature, a separating film of moisture can form on the surface.

Hardness: Mineral substrates must be permitted to fully harden for at least 28 days.

Adhesion: The following tensile strengths must be verified on pre-treated test surfaces:

Concrete: in the centre, at least 1.5 N/mm², individual value not less than 1.0 N/mm².



System description

Substrate pre-treatment

Substrate	Pre-treatment	Primer
Acrylic glass	Abrade with Triflex Cleaner, roughen surface	No primer
Aluminium	Abrade with Triflex Cleaner, roughen surface	No primer ⁽²⁾
Asphalt	Grind	Triflex Cryl Primer 222
Cold bitumen coating	Adhesion test	Triflex Cryl Primer 222
Composite thermal insulation systems		Triflex Pox R 100
Concrete	Grind	Triflex Cryl Primer 276
Copper	Abrade with Triflex Cleaner, roughen surface	No primer ⁽²⁾
FRP / Skylight frame	Abrade with Triflex Cleaner, roughen surface	No primer
Glass	Abrade with Triflex Glass Cleaner, adhesion test	Triflex Glass Primer
Hot bitumen coating	Adhesion test	Triflex Cryl Primer 222
Lightweight concrete		Triflex Cryl Primer 276
Mortar, resin-modified	Grind	Triflex Pox R 100
Paints	Completely grind off	See substrate
Plastic sheeting (PIB)	Roughen surface, adhesion test	On request ⁽¹⁾
Plastic sheeting (PVC-P, nB), EVA	Abrade with Triflex Cleaner	No primer
Plastic sheeting (TPO, FPO, EPDM)	Abrade with Triflex Cleaner, roughen surface, adhesion test compulsory	On request ⁽¹⁾
Plaster/masonry		Triflex Cryl Primer 276
Polymer bitumen sheeting (PY-P) mod. (APP)	Adhesion test	Triflex Cryl Primer 222
Polymer bitumen sheeting (PY-E) mod. (SBS)		No primer
PVC mouldings, rigid	Abrade with Triflex Cleaner, roughen surface	No primer
Screeds	Grind	Triflex Cryl Primer 276
Stainless steel	Abrade with Triflex Cleaner, roughen surface	No primer ⁽²⁾
Steel, galvanised	Abrade with Triflex Cleaner, roughen surface	No primer ⁽²⁾
Wood	Remove paints	Triflex Cryl Primer 276
Zinc	Abrade with Triflex Cleaner, roughen surface	No primer ⁽²⁾

⁽¹⁾ Depending on the type of sheeting, e.g., using Triflex Primer 610.

⁽²⁾ Alternative to roughening: Abrade with Triflex Cleaner, prime with Triflex Metal Primer. Loose rust and blistering rust must first be removed. Information on other substrates is available on request (technik@triflex.de).

Important note:

Adhesion to the substrate must be checked on a case-by-case basis!

Primer

Triflex Cryl Primer 222

Apply evenly with a Triflex universal roller.
Volume: at least 0.40 kg/m².
Can be recoated after approx. 45 min.

Triflex Cryl Primer 276

Apply evenly with a Triflex universal roller.
Volume: at least 0.40 kg/m².
Can be recoated after approx. 45 min.

Triflex Glass Primer

Wipe up evenly with a cleaning cloth GP.
Volume: approx. 50 ml/m².
Can be recoated after approx. 15 min up to max. 3 hrs.

Triflex Metal Primer

Apply thinly with a short-pile roller or, alternatively, spray on thinly with a spray can.
Volume: approx. 80 ml/m².
Can be recoated after approx. 30 to 60 min.

Triflex Pox R 100

Apply evenly using a Triflex universal roller and immediately sand down with plenty of quartz sand.
Volume of Triflex Pox R 100: at least 0.30 kg/m²,
Volume of quartz sand 0.2–0.6 mm: at least 2.00 kg/m².
Can be recoated after approx. 12 hrs.

Triflex Primer 610

Apply evenly with a brush or roller.
Volume: approx. 40 to 80 g/m².
Can be recoated after approx. 20 min.



System description

Detail waterproofing

Application is wet-in-wet.

1 Triflex ProDetail

Apply evenly with a radiator roller.

Volume: at least 2.00 kg/m².

2 Triflex Special Fleece

Lay fleece strips, removing any air bubbles.

Overlap the fleece strips by at least 5 cm.

3 Triflex ProDetail

Apply until the Triflex Special Fleece is fully saturated.

Volume: at least 1.00 kg/m².

Total volume of Triflex ProDetail: at least 3.00 kg/m².

Can be recoated after approx. 45 min.

For dimensions, see Triflex ProDetail system drawings.

Detail waterproofing for hard-to-reach areas:

Triflex ProFibre

Apply with a brush.

Volume: approx. 3.00 kg/m².

Rainproof after approx. 30 min.

Can be recoated after approx. 45 min.

Joint waterproofing

1. PE round sealing band

Seal on top of the joint.

Points 2 to 4 are completed wet-in-wet.

2. Triflex ProDetail

Apply at least 10 cm to both sides of the joint with a radiator roller.

Volume: at least 2,00 kg/m².

3. Triflex Special Fleece

Lay fleece strips, removing any air bubbles.

Overlap the ends of the fleece strips by at least 5 cm.

4. Triflex ProDetail

Apply until the Triflex Special Fleece is fully saturated.

Volume: at least 1,00 kg/m².

Total volume of Triflex ProDetail: at least 3,00 kg/m².

Rainproof after approx. 30 min.

Can be recoated after approx. 45 min.

For dimensions, see Triflex ProDetail system drawing

Finishing

The sealing of all vertical junctions, transitions and details must be carried out prior to the surface finishing with thixotropic Triflex Cryl Finish 205. The product is thickened by the in-situ addition of 1 wt. % Triflex Liquid Thixo.

Triflex Cryl Finish 205

Cross-coat evenly using a Triflex finish roller.

Volume: at least 0.50 kg/m².

Can be walked on after approx. 2 hrs.

What to do if work is interrupted

If work is interrupted for more than 12 hrs, or if soiled by rain etc., the intersection must be activated with Triflex Cleaner. Airing time: at least 20 min. Transitions to subsequent waterproofing must overlap (incl. Triflex Special Fleece) by a minimum of 10 cm. This also applies to junctions, transitions and detail solutions with Triflex ProDetail. The finish must be applied within 24 hrs. If this application is delayed for any reason, the surface to be finished must be pre-treated with Triflex Cleaner.



System description

System components

For information on applications, conditions for use and instructions for mixing, see product information (request if necessary):

Triflex Cleaner
Triflex Cryl Finish 205
Triflex Cryl Primer 222
Triflex Cryl Primer 276
Triflex Glass Primer
Triflex Liquid Thixo
Triflex Metal Primer
Triflex Pox R 100
Triflex Primer 610
Triflex ProDetail
Triflex ProFibre
Triflex Special Fleece

Quality standard

All Triflex products are manufactured in accordance with the standards defined in ISO 9001. To ensure quality is not compromised, Triflex products are only installed by specialist, fully trained and qualified contractors.

Safety tips / Accident prevention

Read the safety data sheets before using the products.

Volumes required / Waiting times

The specified volumes apply only to smooth, even surfaces. Special allowances must be made for unevenness, roughness and porosity. Information regarding airing and waiting times applies to a substrate at an ambient temperature of +20 °C.

General notes

The basis for the use of Triflex products can be found in the system descriptions, system drawings and product information sheets. It is essential to heed these when planning and carrying out the building project. Departures from the technical information of Triflex GmbH & Co. KG applicable at the time of work can compromise the guarantee. Any project-related departures are subject to the written authorisation of Triflex.

All data is based on general regulations, directives and other technical rules. The general regulations applicable in the particular country of use must be respected. Since the parameters can vary from case to case, the user is required to test the suitability, e.g., of the substrate.

Non-system substances must not be added to Triflex products. Subject to change in the interests of technical advancement or enhancement of Triflex products.

Tender texts

Please visit the download section of the Triflex website at www.triflex.com to obtain the current standard specifications for tender, which are available in a range of different file formats.

CAD drawings

All CAD system drawings can be downloaded free of charge from the download section of the Triflex website www.triflex.com.



System drawings

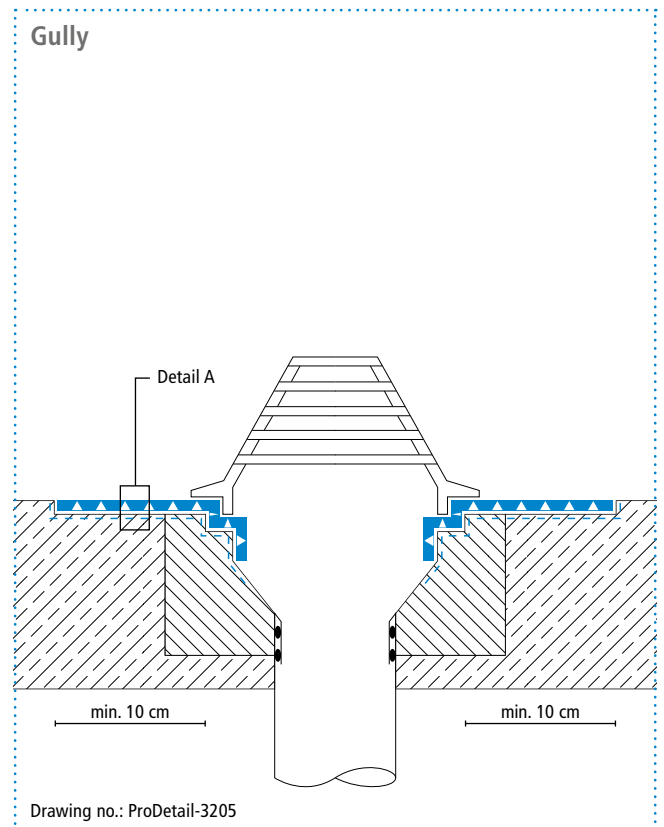
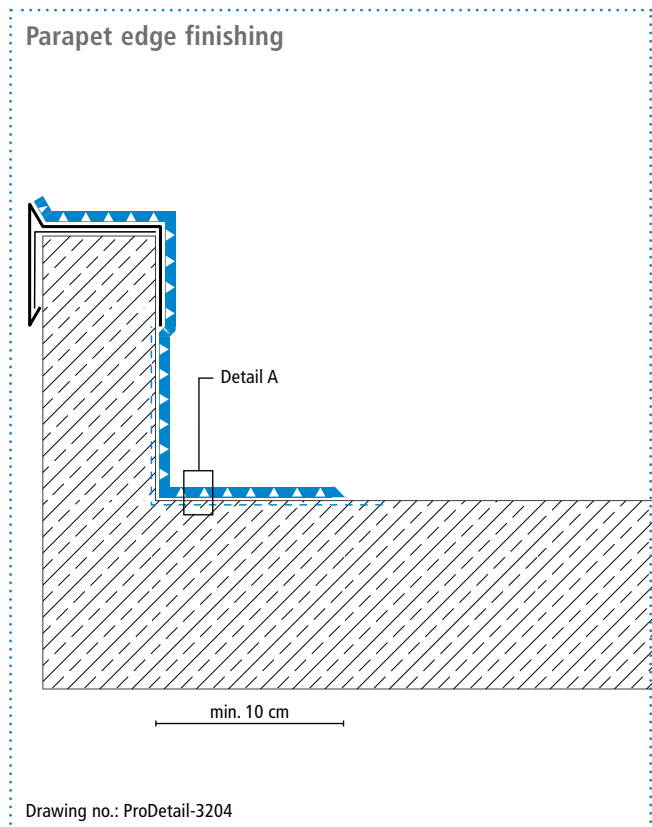
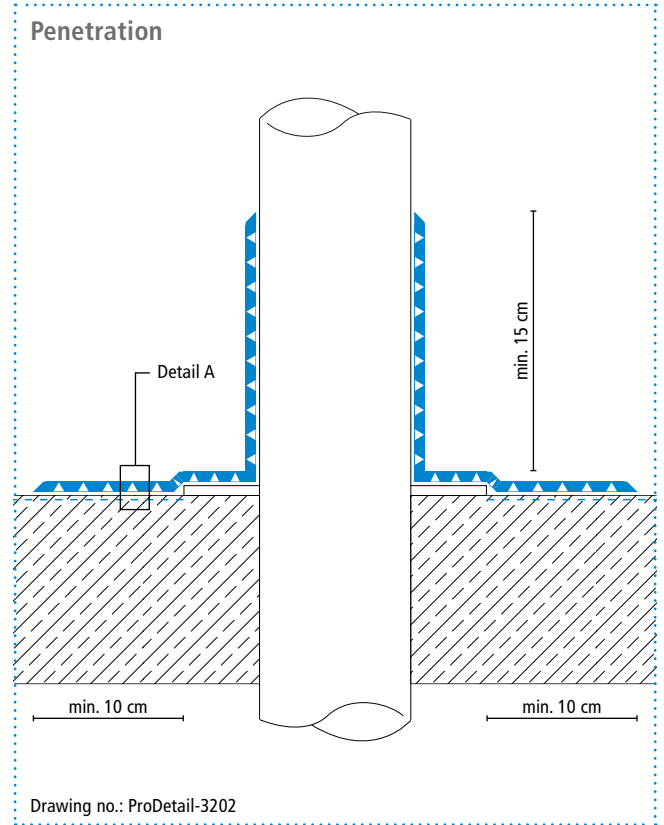
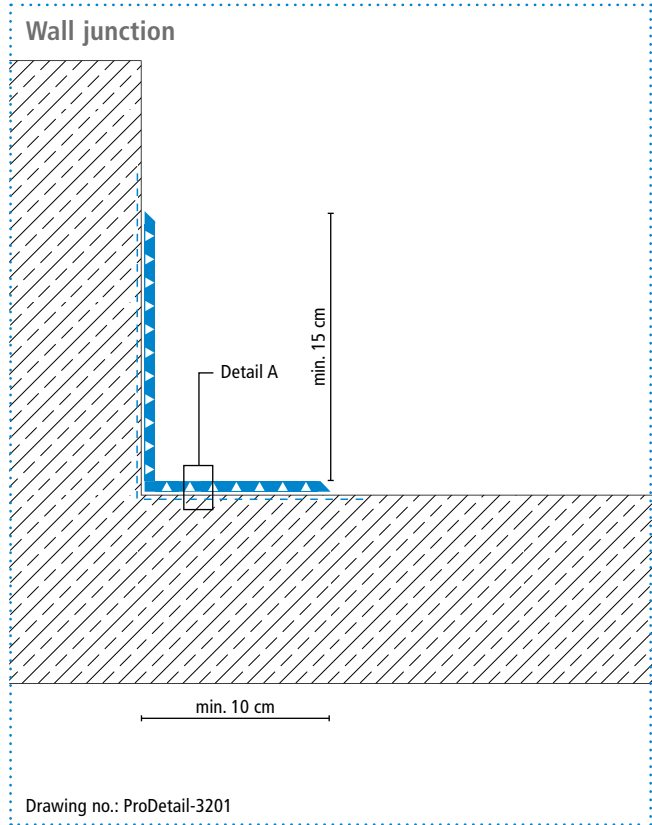

Height differences between fleece overlaps are exaggerated.



System drawings

Rooflight

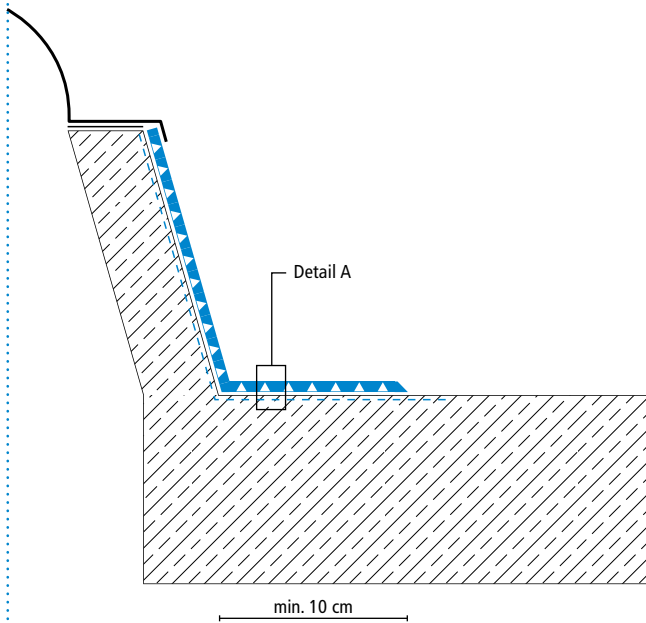

Drawing no.: ProDetail-3203

System design – Detail A

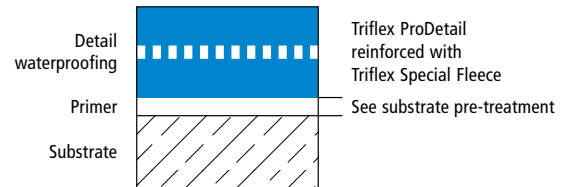

Edge finishing with bracket-mounted gutter

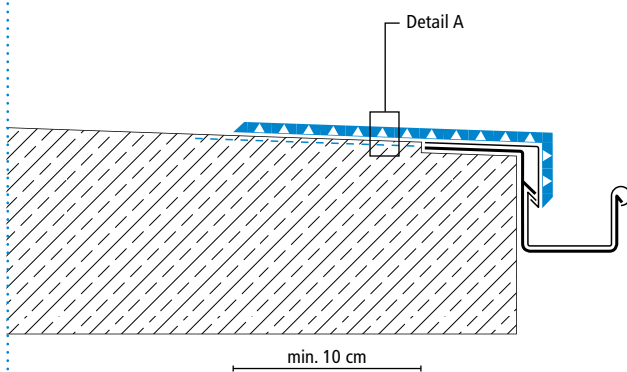

Drawing no.: ProDetail-3206

Settlement joint

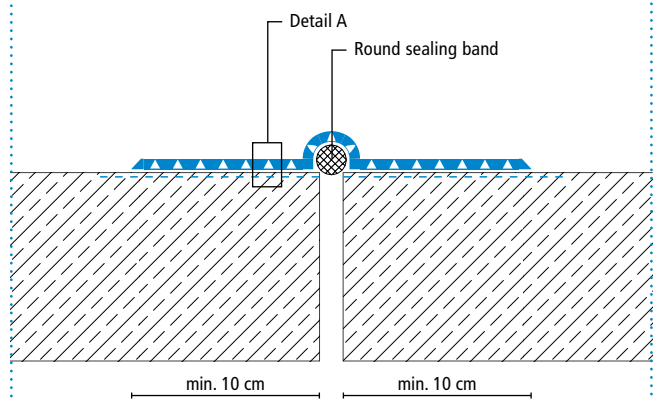

Drawing no.: ProDetail-3207

Height differences between fleece overlaps are exaggerated.



Detail Waterproofing System Triflex ProDetail®

Colours

Waterproofing – Triflex ProDetail



7032 Pebble grey



7035 Light grey



7043 Traffic grey

Finish – Triflex Ceryl Finish 205



7030 Quartz 03 (Stone grey)

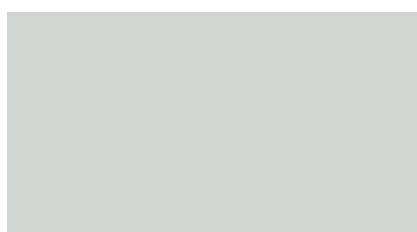

7035 Quartz 01 (Light grey)



7037 Slate 02 (Dusty grey)



7040 Slate 01 (Window grey)



7043 Slate 03 (Traffic grey)



7073 Malachite 04

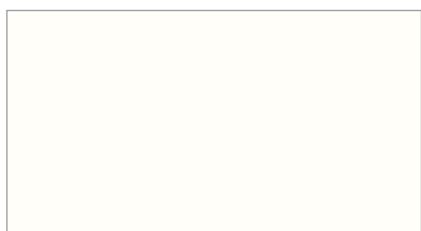

9010 Sand 01 (White)

Please note:

Minor variations between the colours shown here and the actual colours are due to printing technology and the materials used.



Different roof constructions

Waterproofing for roofs without thermal insulation



The full-surface fleece-reinforced Triflex waterproofing system provides seamless and jointless roof waterproofing, with no need for any additional surface protection.

Waterproofing for non-ventilated roofs

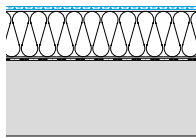

Over the thermal insulation (with support layer), the Triflex waterproofing system reliably waterproofs the building shell.

Waterproofing for inverted roofs

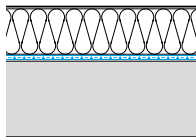

With inverted roofs, the Triflex waterproofing system forms the seamless waterproofing membrane underneath the thermal insulation.

Waterproofing under other coverings

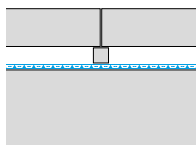

The Triflex waterproofing system provides long-lasting protection under loose coverings and their sub-structures.

Waterproofing under screed

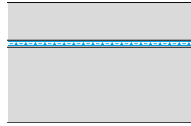

Triflex waterproofing systems with a PMMA resin base are resistant to alkalis and hydrolysis. They can be used under concrete, screed and tiles without any problems.

Waterproofing under ponding water

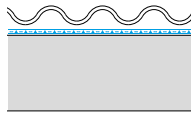

The waterproofing systems Triflex ProTect and Triflex ProDetail are suitable for waterproofing ornamental fountains, sprinkler systems and water tanks.

Waterproofing that can be walked on

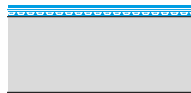

For maintenance paths, there are non-slip Triflex waterproofing systems available. Waterproofing with a higher load resistance is also possible.

Waterproofing for green roofs

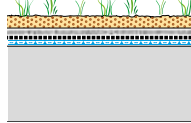

Triflex waterproofing systems are suitable for use under roof greening (root and rhizome-resistant).



Specific details with Triflex ProFibre

Triflex ProFibre is a 2-component fibre-reinforced waterproofing product with a PMMA resin base, which needs no additional fleece reinforcement. The waterproofing resin is particularly suitable for details that are difficult to get to for structural reasons, making it impossible to use a fleece-reinforced waterproofing system.

Triflex

Delivering solutions together.



International

Triflex GmbH & Co. KG
Karlsruhe 59
32423 Minden | Germany
Fon +49 571 38780-0
info@triflex.com
www.triflex.com